

SIDLER

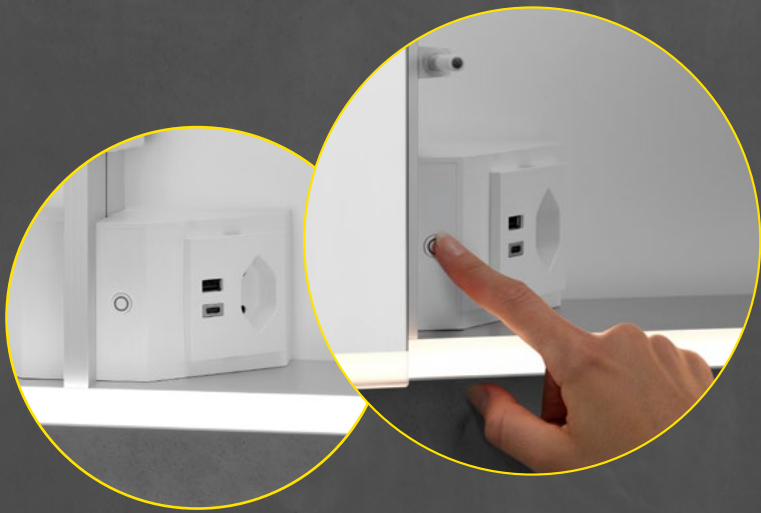

USER MANUAL
LIGHT CONTROL



MODELS WITH ONE BUTTON

Switching the light on and off:

The light is switched on and off via the wall switch.

Dimming the light:

Increasing brightness

1. Press and hold the button: the light becomes brighter.
2. Release the button at the desired brightness.

Decreasing brightness

1. Press and hold the button again: the light becomes dimmer.
2. Release the button at the desired brightness.

Activating night light:

Press the button briefly once: the upper light switches off, the lower light remains on.

Activating main light:

Press the button briefly again: the upper light switches back on.

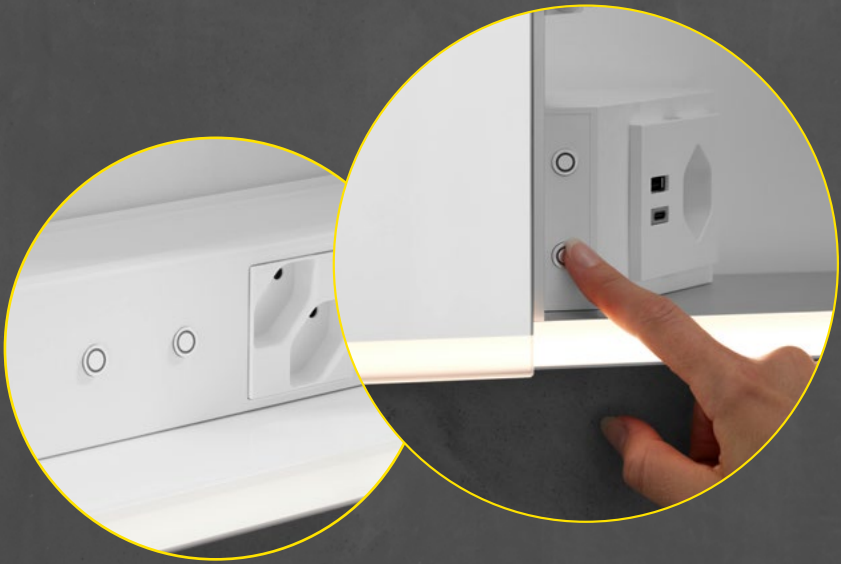

MODELS WITH TWO BUTTONS

Switching the light on and off:

The light is switched on and off via the wall switch.

Dimming the light:

Increasing brightness

1. Press and hold button 1: the light becomes brighter.
2. Release at the desired brightness.

Decreasing brightness

1. Press and hold button 1 again: the light becomes dimmer.
2. Release at the desired brightness.

Adjusting color temperature:

Warmer light

1. Press and hold button 2: the light becomes warmer.
2. Release at the desired color temperature.

Cooler light

1. Press and hold button 2 again: the light becomes cooler.
2. Release at the desired color temperature.

Activating night light:

Press any button briefly once: the upper light switches off, the lower light remains on

Activating main light:

Press any button briefly again: the upper light switches back on.

Watch Video: [sidler.swiss/cirrus/](https://www.sidler.swiss/cirrus/)

For models with a continuous light strip, the night light function is not available.



MODELS WITH TOUCH SENSOR

Switching the light on and off:

The light is switched on and off via the wall switch.

Dimming the light:

Increasing brightness

1. Press and hold the touch sensor: the light becomes brighter.
2. Release at the desired brightness.

Decreasing brightness

1. Press and hold again: the light becomes dimmer.
2. Release at the desired brightness.

Activating night light: Tap the touch sensor briefly once: the upper light switches off, the lower light remains on.
Tap again: the upper light switches back on.

Night light function is only available for models with lower lighting

Touch sensor location:

Either on the outside at the bottom right or inside above the socket

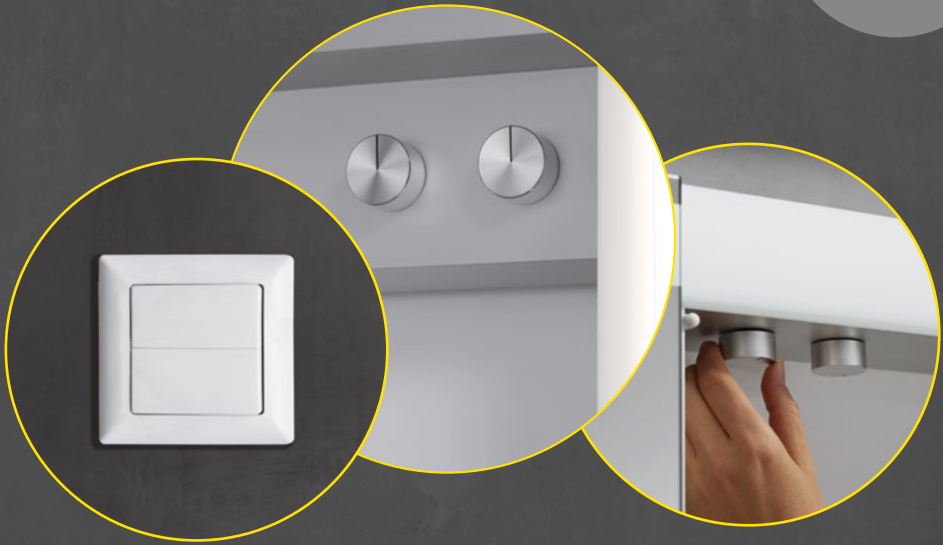

MODELS WITH TWO-SWITCH SYSTEM (SIDLER SWITCH)

Switching the light on and off:

The light is controlled via a wall switch (two-switch system).

1. Main light (up and down):
Press the upper wall switch.
2. Night light (downwards):
Press the lower wall switch.

Presetting the main light:

1. Switch on the main light.
2. Use rotary control 1 to select the color temperature.
3. Use rotary control 2 to select the brightness.
4. The setting is saved immediately.

Voreinstellung Nachtlicht:

1. Switch on the night light.
2. Use rotary control 1 to select the color temperature.
3. Use rotary control 2 to select the brightness.
4. The setting is saved immediately.

Watch Video: sidler.swiss/focus/

SIDLER
●